

ELD MANDATE HOURS OF SERVICE

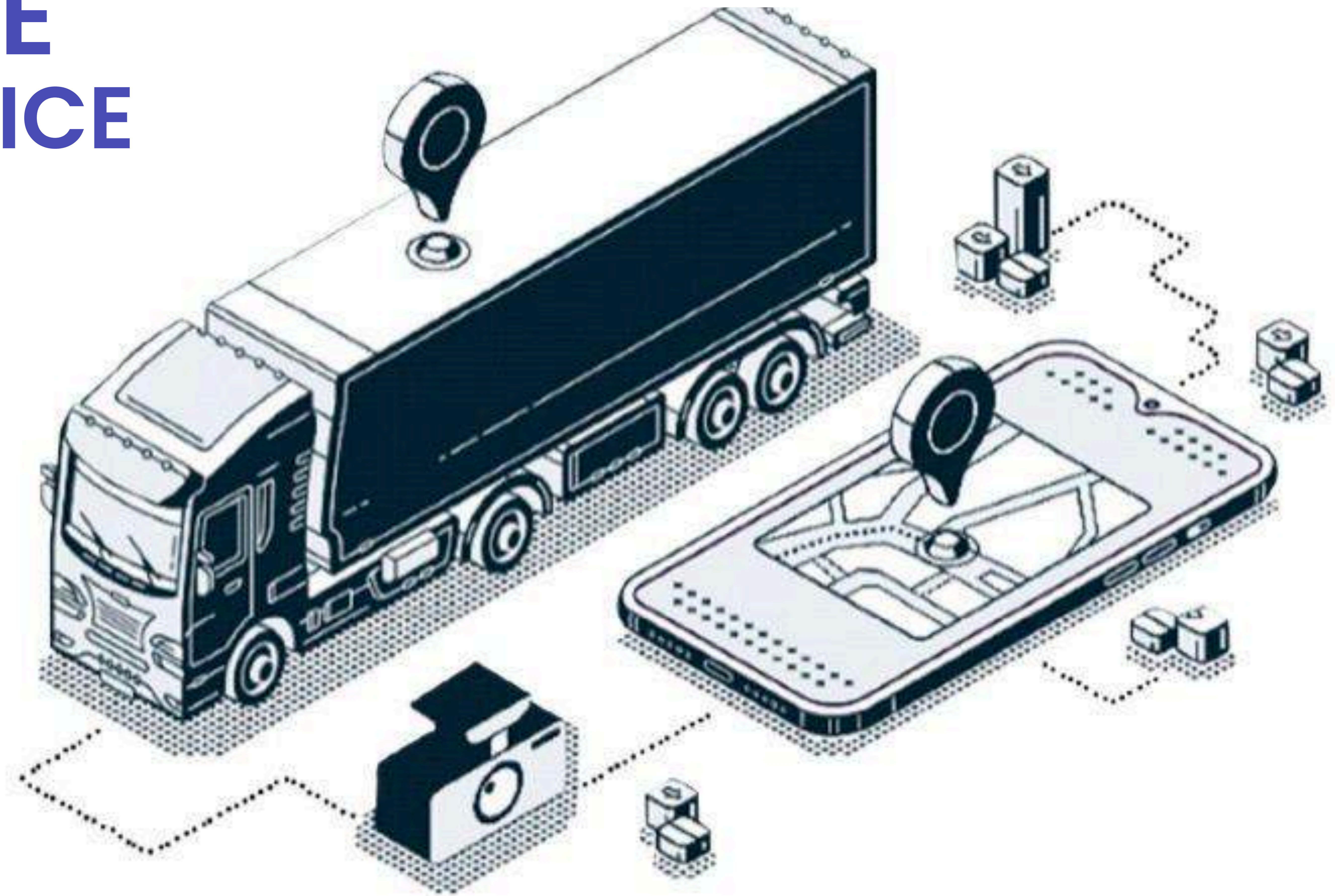

Online
supportdesk@eldmandate.biz



Support Phone Number
1-800-601-4511

ELD MANDATE USER MANUAL GUIDE AND DOT REFERENCE CARD

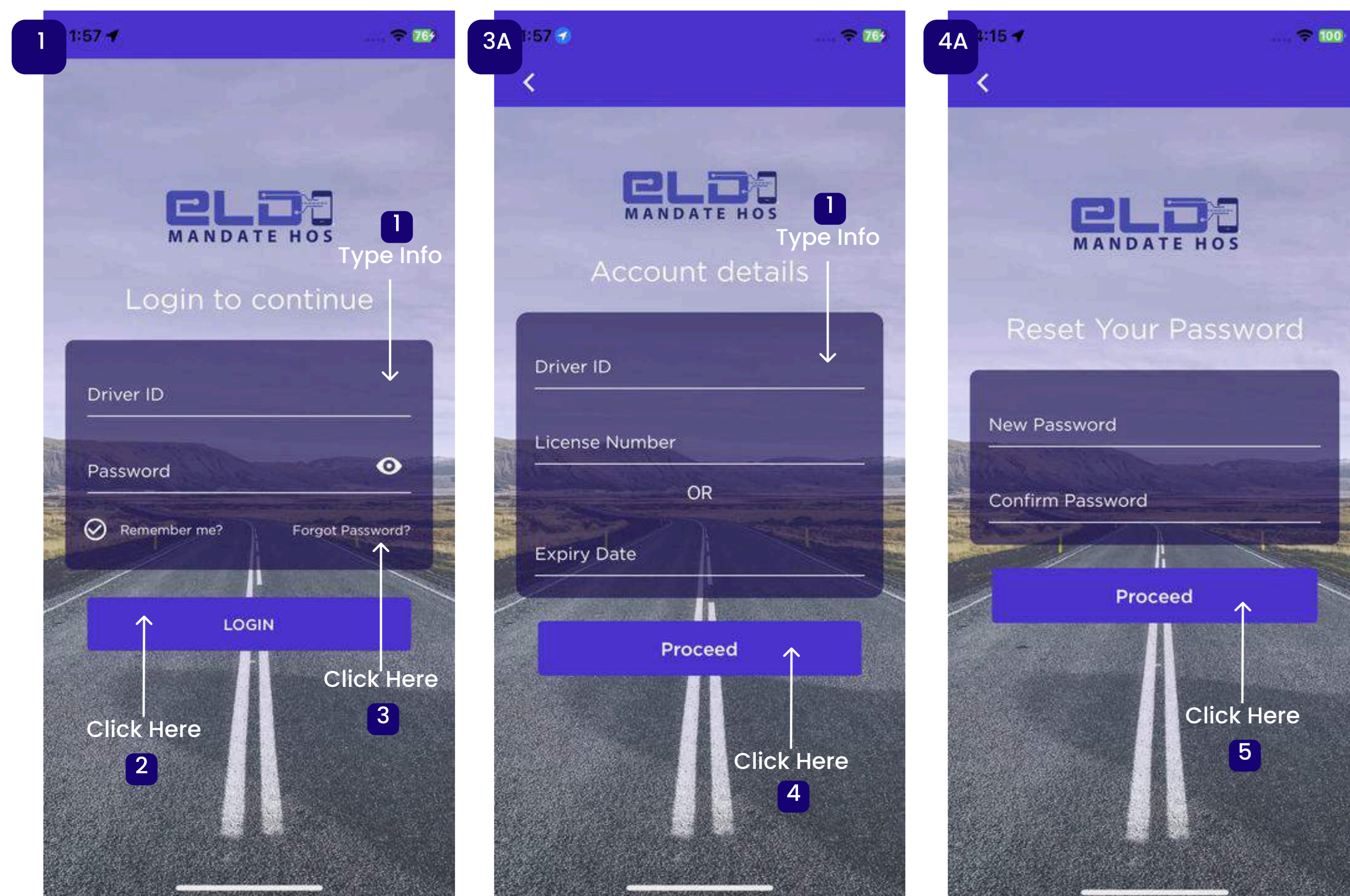

Log in/ Forgot Password

Back to 1

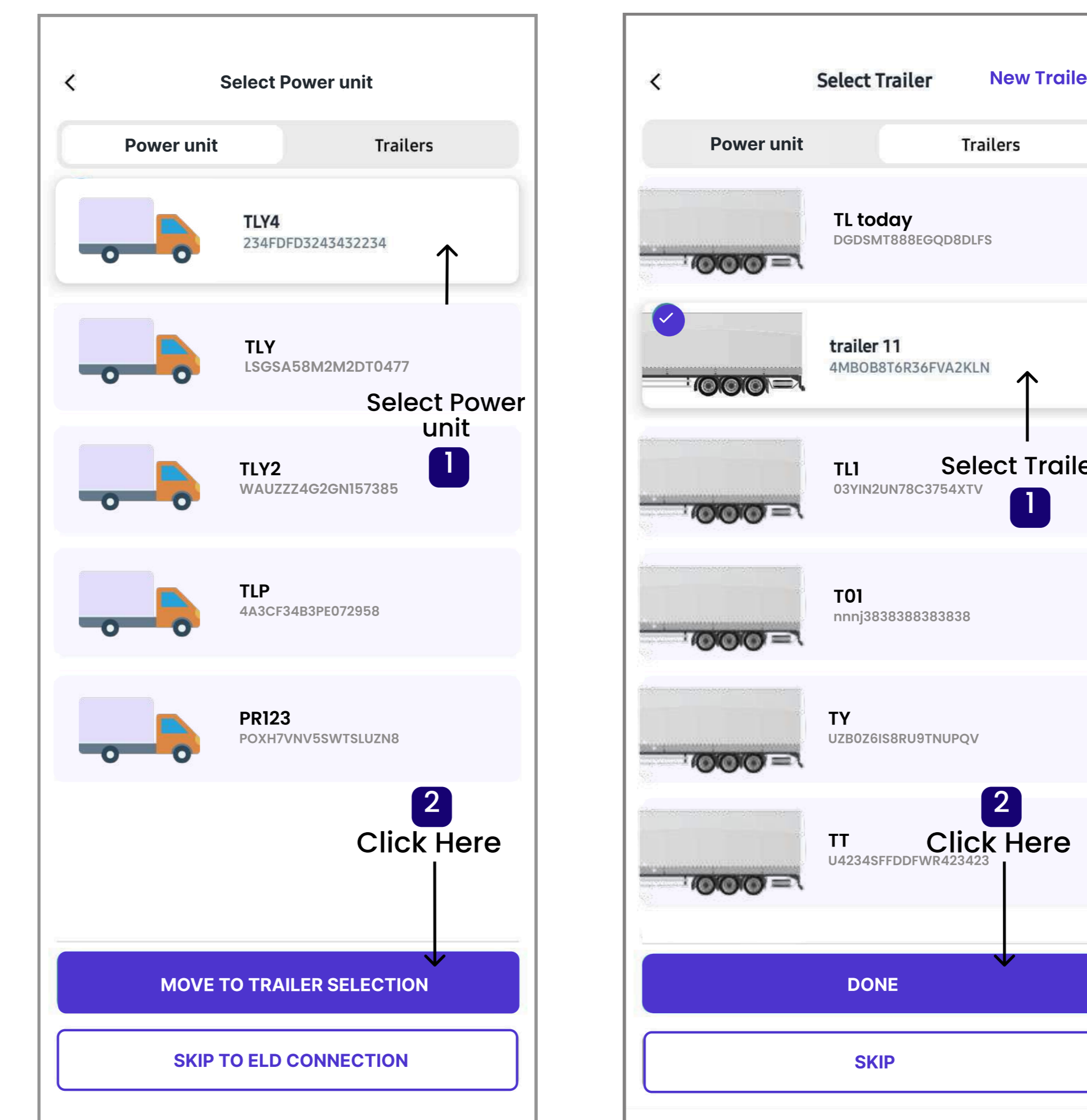

Truck Selection

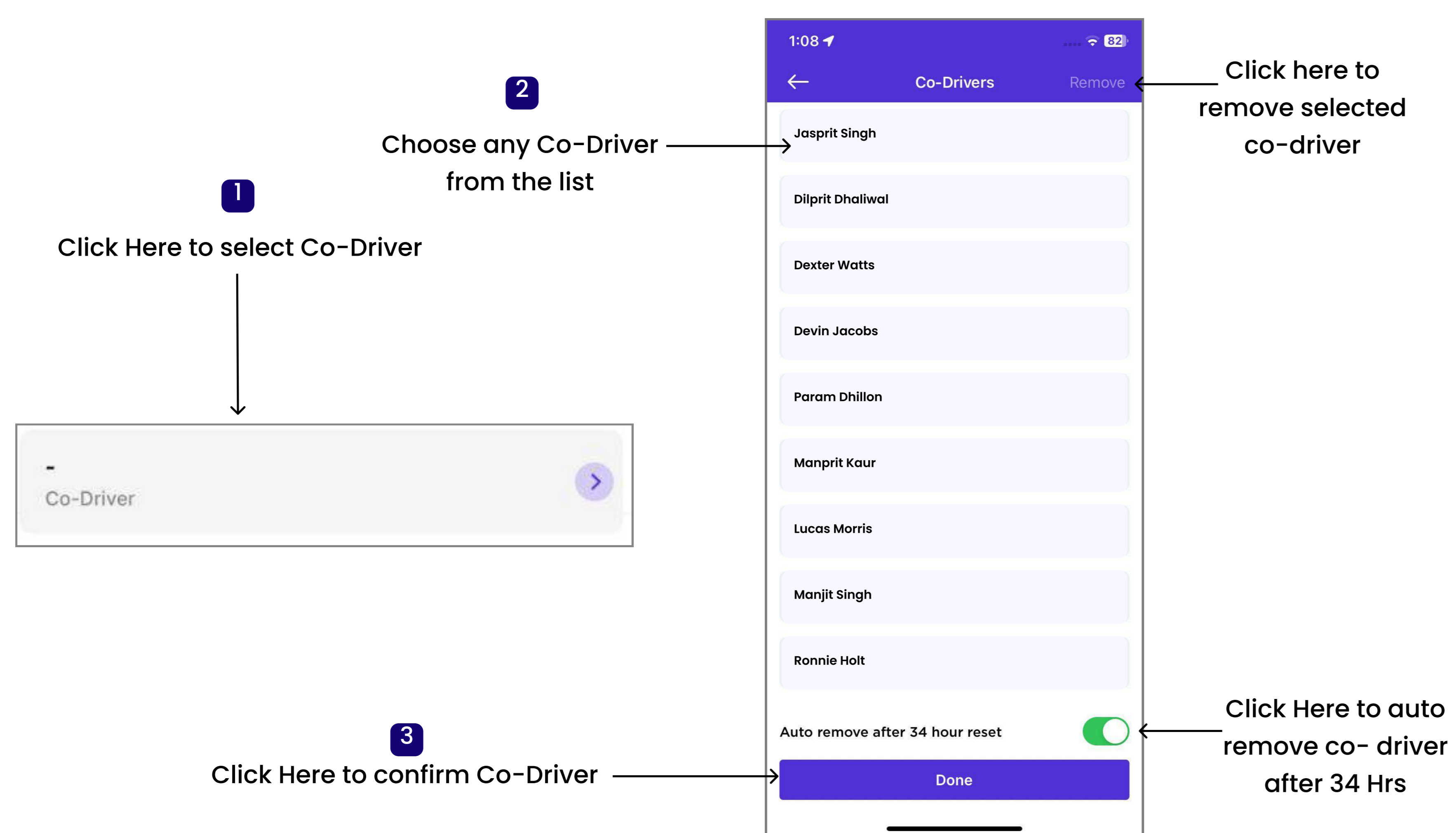

Co- Driver Selection

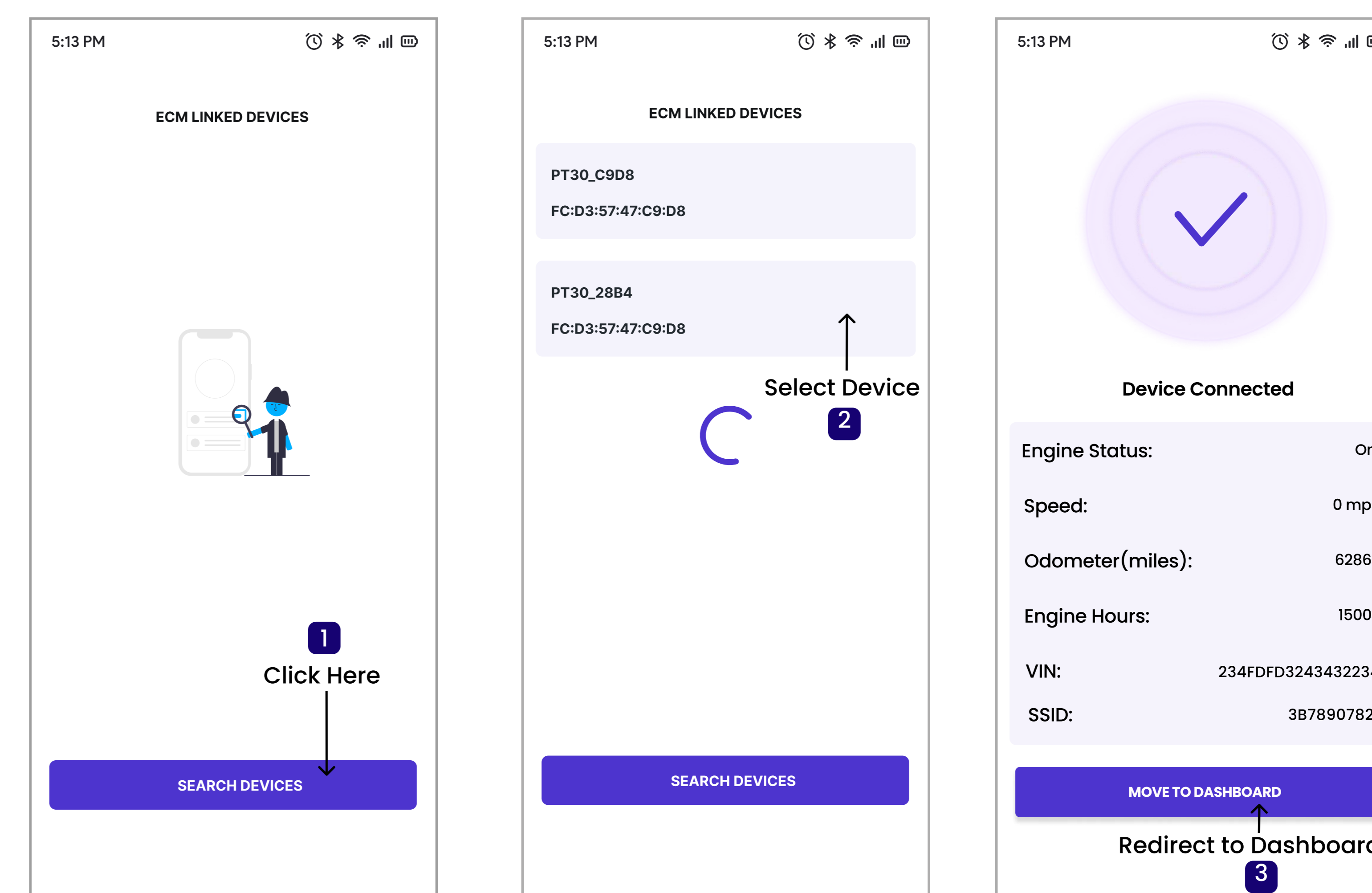

Pair ELD & Confirm Connection

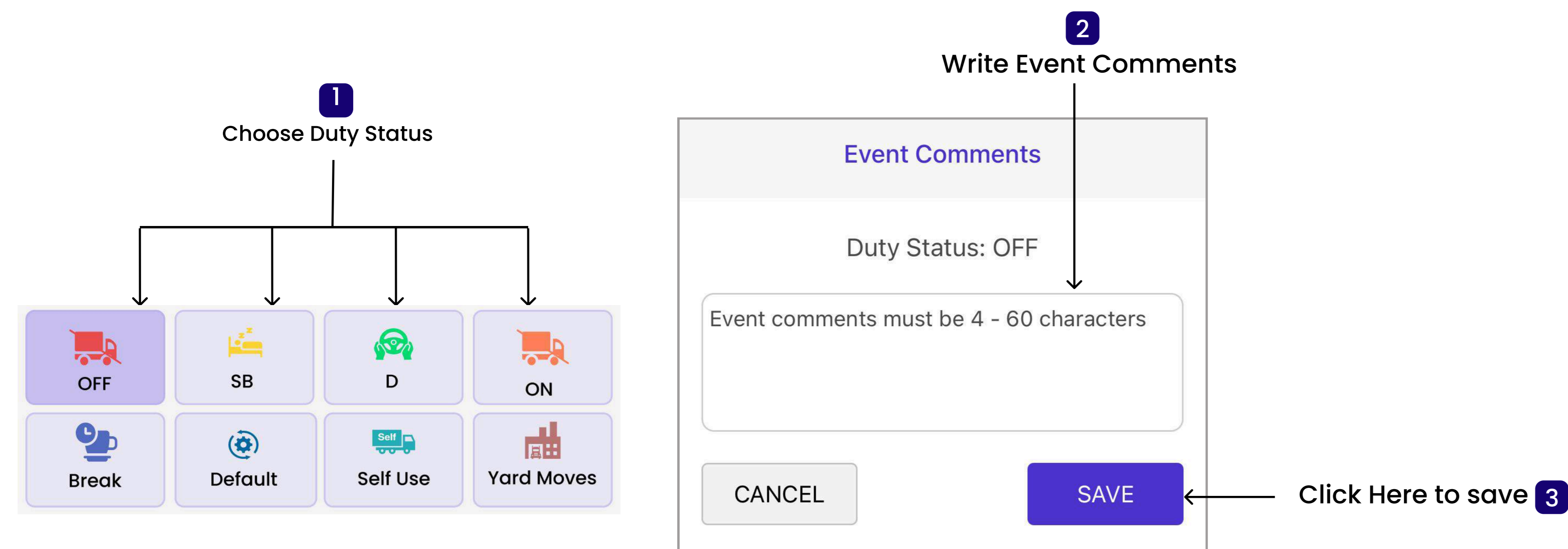

Choose Duty status & Add Comments

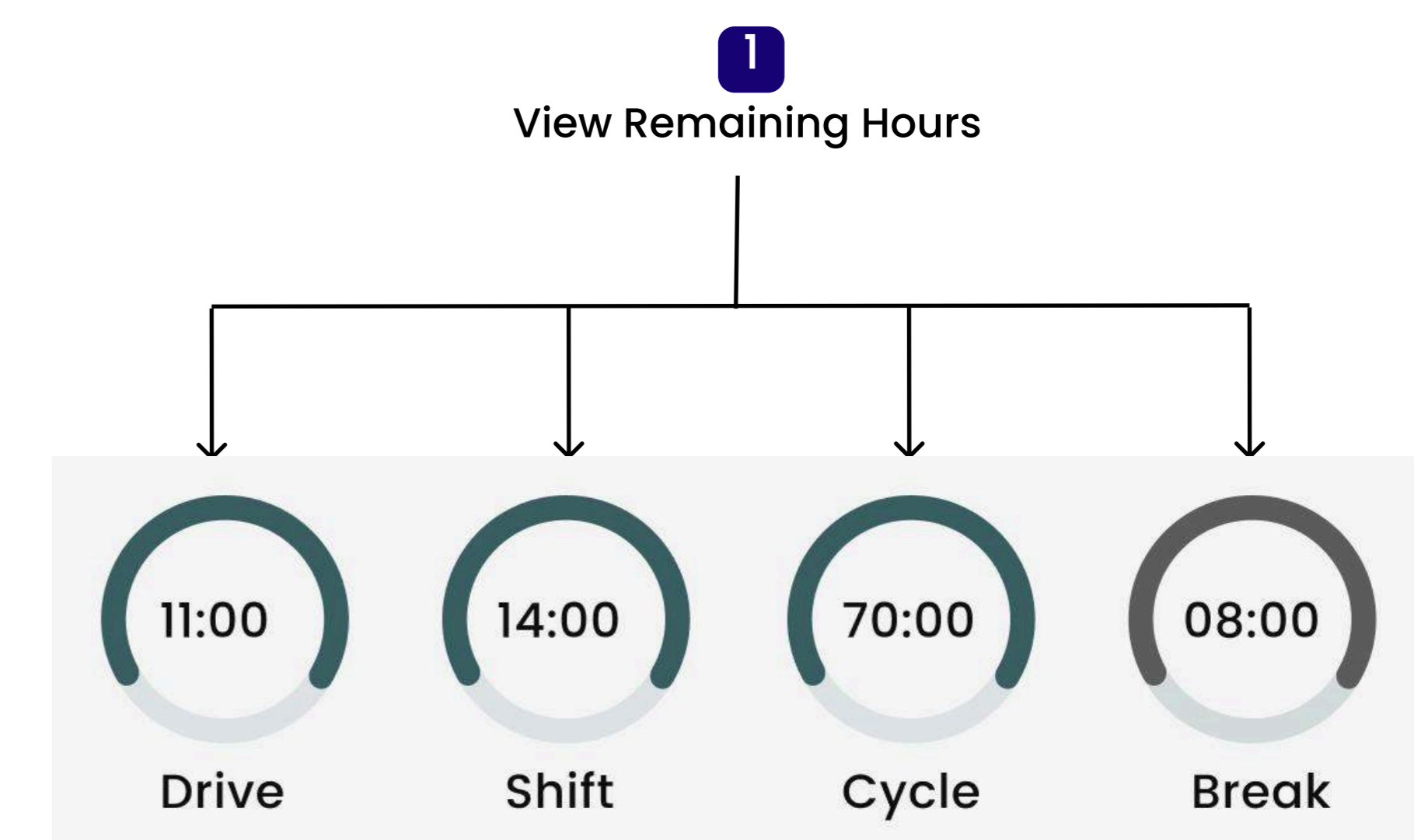

Timers

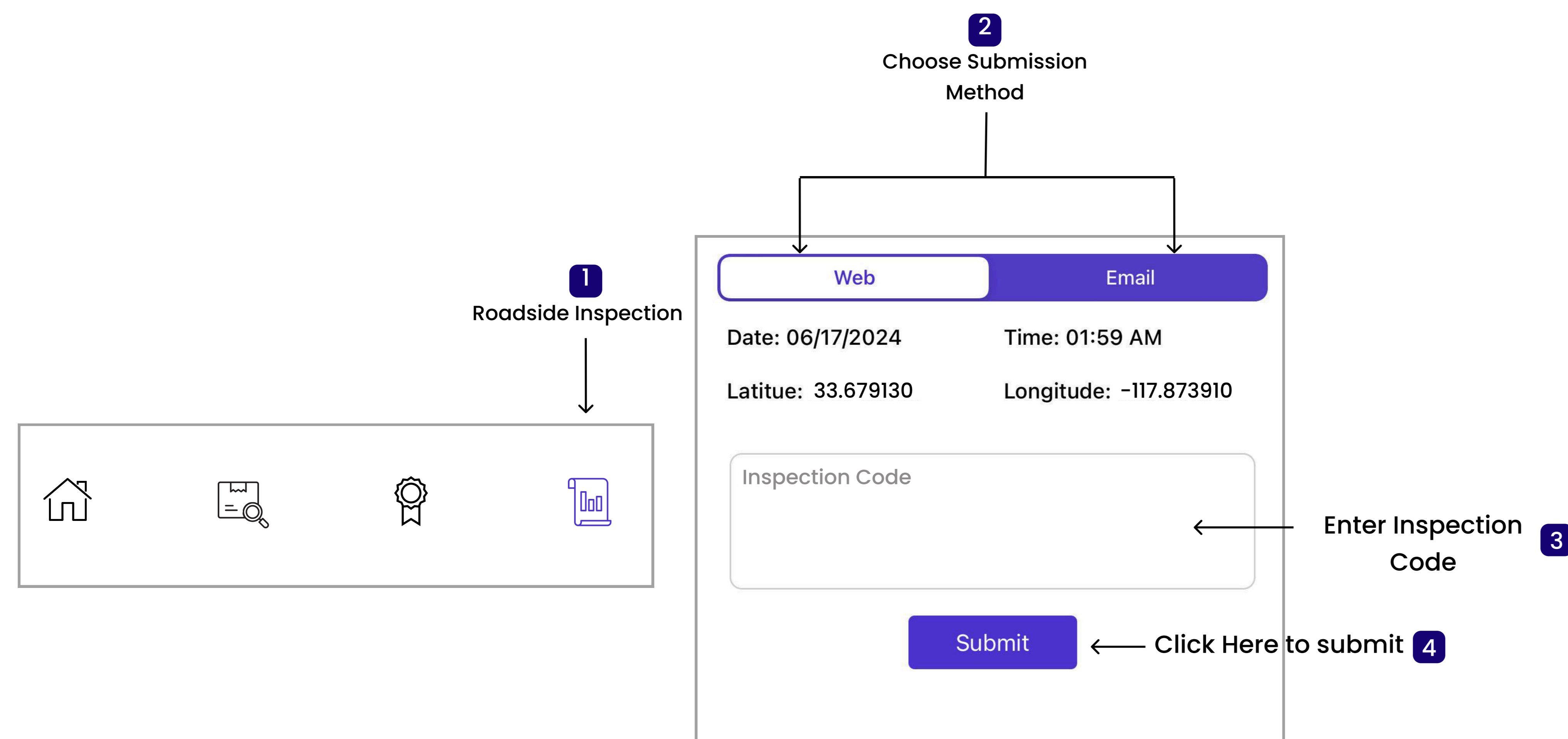

Transfer to ERODS

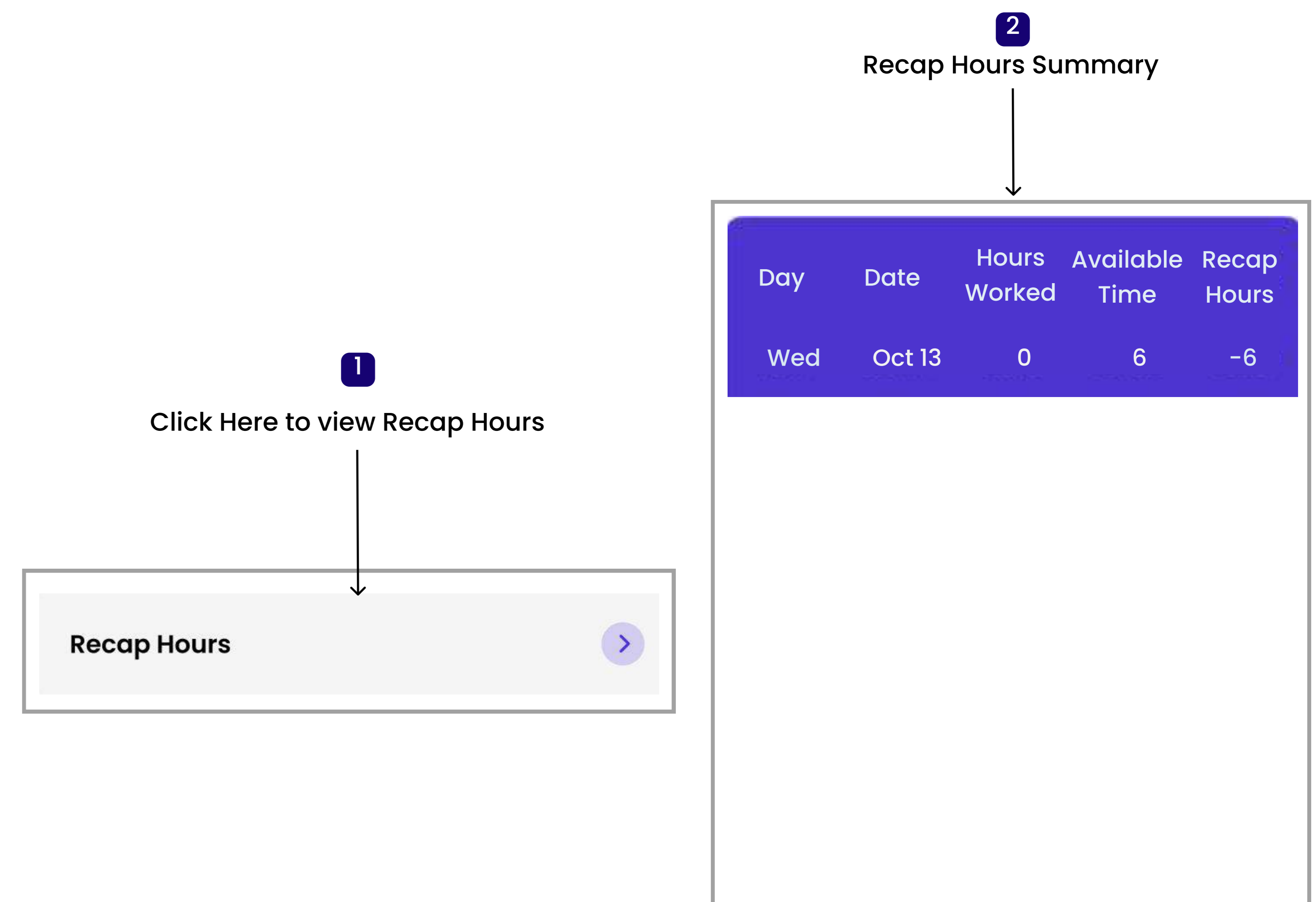

Recap Hours

1 Click on Load sheet

2 Fill in all the fields

3 Click here to save load sheet

Add Load Sheet

1 Click on DVIR (Ensure you are connected to ELD)

1 Click on this drop down to select Vehicle number

2 Choose a vehicle from the list

3 Click here to save DVIR

DVIR

1 Click on Load sheet

2 Select appropriate exception

3 Click here to save exception

Exception

1 Click on Fuel Purchase

2 Fill in all the fields

3 Click here to save

Fuel Purchase

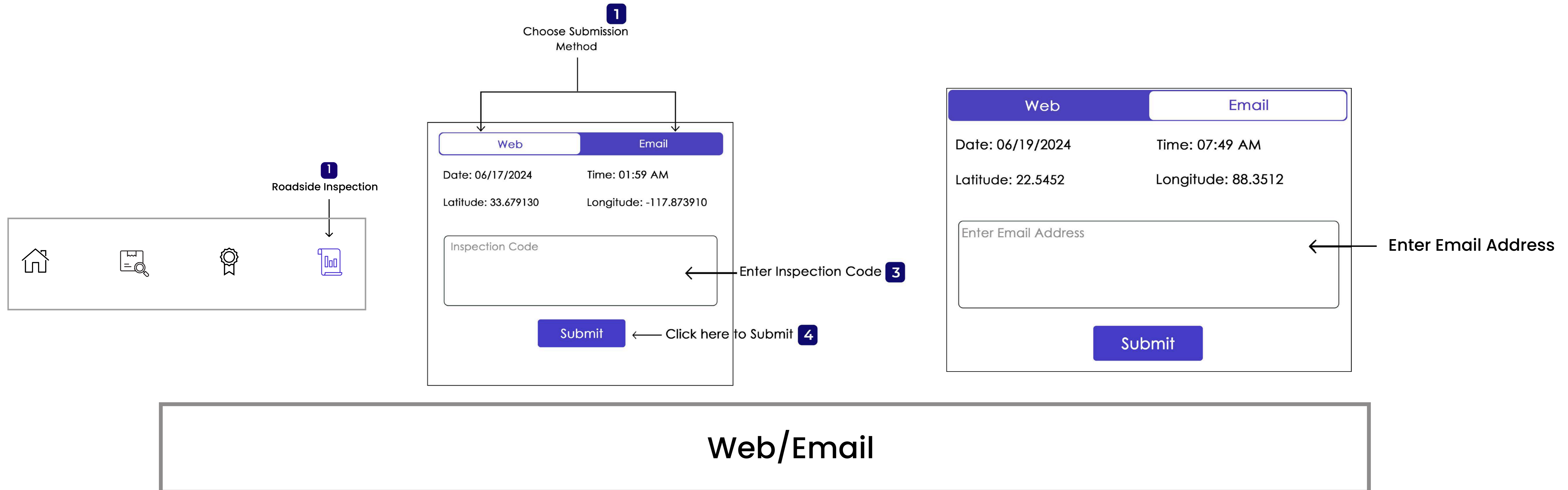

In Log Report, you can view 3 Tabs: Header, Chart, and Events.

a. Header:

- View the Current Location, Driver, Co-Driver, Vehicle, ELD, and Carrier details.

b. Chart:

- Displays the Hours Of Service of drivers in a chart view (graphical representation).

c. Event Logs:

- Displays the details of each event, including Event start time, Location, Odometer, Engine Hours, Origin, Event Type/Status, and Event Comments.
- It will display violation-related information if the driver exceeds the duty limitations.
- You can share the Log report by entering the desired email and clicking on send.

Review Driver's Daily Log

a.

RECORD DATE	US DOT #	Driver Licence Number
17-Jun-2024	12345	TESTUSER123
Driver Licence State	ELD ID	Trailer Id
DELAWARE	3B5000132183	T01
Time Zone	Driver Name	Co-Driver Name
GMT+5:30, Asia/Kolkata	User, Test	

b.

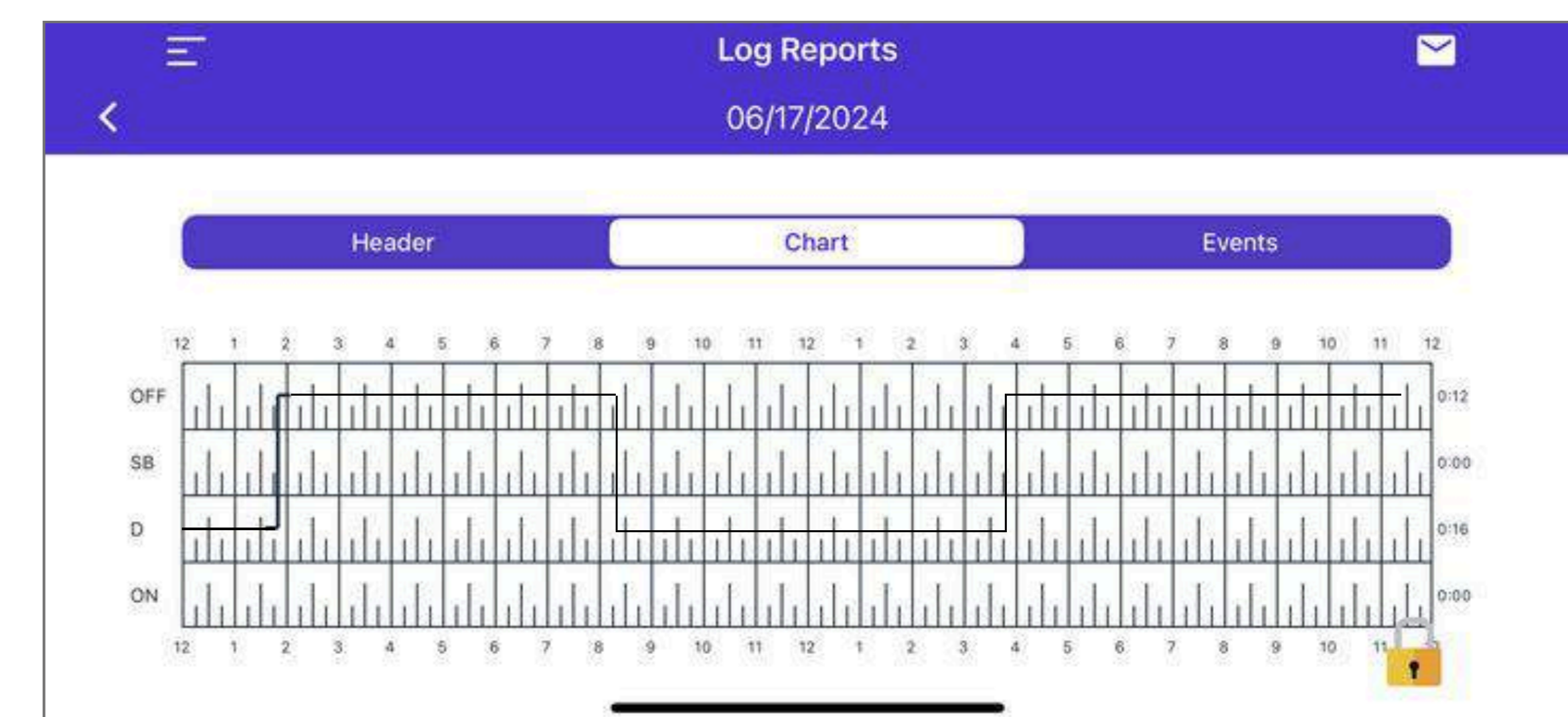

c.

Time	Event	Location	Odometer (Miles)	Eng hrs	Origin
03:35 AM	Driver Login	Location not available	0	0	Manual